

Title Center

Office Space for Lease



**2211 Lee Road,
Winter Park, FL 32789**

Property Details:

Total Space Available	1,369 RSF
Rental Rate	TBD
Min. Divisible	1,369 RSF
Max. Contiguous	1,369 RSF
Property Type	Office
Building Size	19,923 SF
Class	B
Zoning Description	O-1

Spaces:

Suite	Space Available	Term	Price	Lease Type	Date Available	Description
2211 - Suite 210	1,369 RSF	Negotiable	\$20.00 PSF	Full Service	April 1, 2023	See attached floor plan

Location Description:

- Window view in each office
- Winter Park address/ Good Parking
- Convenient access to I-4 and US Hwy 17-92
- Minutes from Downtown Winter Park, Downtown Orlando, Maitland, and Altamonte Springs
- Close to new retail / restaurants in Winter Park & Bus Line



Commercial Sales & Leasing | Property Management | Project Development | Acquisitions & Dispositions | Construction Services

Southeastern Realty Group, Inc. - 933 Lee Road Suite 400 - Orlando, FL 32810 - t: 407-629-5595 - f: 407-645-2035

2211 Lee Road - Suite 210 Floorplan:

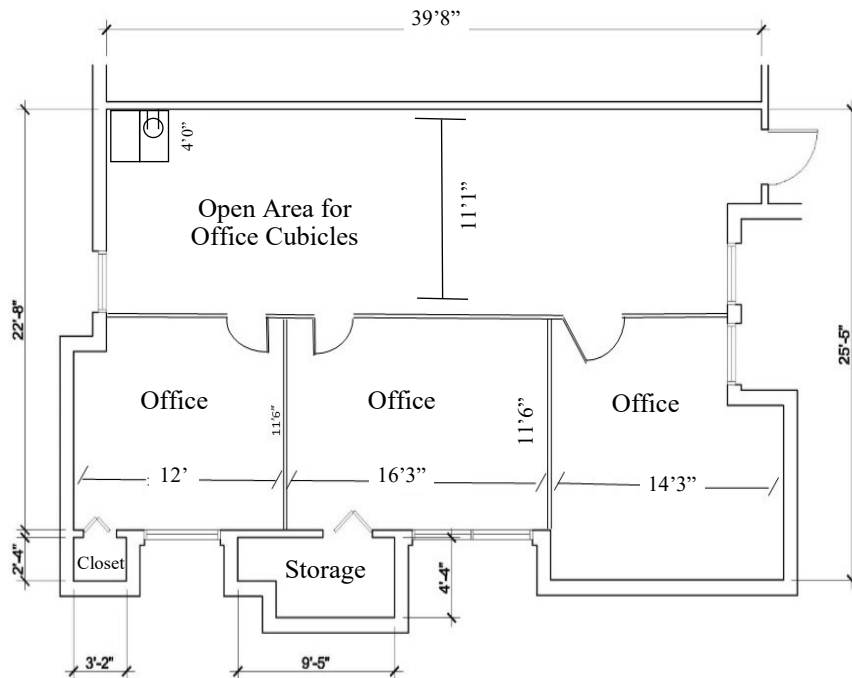

Suite 210
1,369 RSF



SCALE: 1/8" = 1'-0"

2211 LEE ROAD
OFFICE BUILDING
ORLANDO, FLORIDA



1,369 RSF Available

Southeastern Realty Group
933 Lee Road, Suite 400, Orlando, Florida 32810
407-629-5595 phone, 407-645-2035 fax
Visit our website at www.southeasternrealty.com

The information contained herein is from sources deemed reliable, but no warranty or representation is made as to the accuracy thereof and no liability may be imposed.