

# Medical Arts

## Medical Office Space for Lease



2900 17th Street,  
Saint Cloud, Florida, 34769

### Property Details:

Total Space	4,442 RSF
Min. Divisible	1,516 RSF
Max. Contiguous	4,442 RSF
Property Type	Office
Property Sub-type	Medical Office
Building Class	B

### Spaces:

Suite	Space Available	Min Divisible	Max Contiguous	Date Available	Description
2, 6	2,926 RSF	2,926 RSF	2,926 RSF	Now	Medical Office
3	1,516 RSF	1,516 RSF	1,516 RSF	Now	Medical Office

### Location Description:

- Medical office space with proximity to local hospital in Kissimmee / Saint Cloud area
- Property is on campus of Saint Cloud Hospital
- Direct parking lot access



Commercial Sales & Leasing | Property Management | Project Development | Acquisitions & Dispositions | Construction Services

Southeastern Realty Group, Inc. - 933 Lee Road Suite 400 - Orlando, FL 32810 - t: 407-629-5595 - f: 407-645-2035

# Floor Plans:

## MEDICAL ARTS BUILDING 2900 17th Street, St Cloud

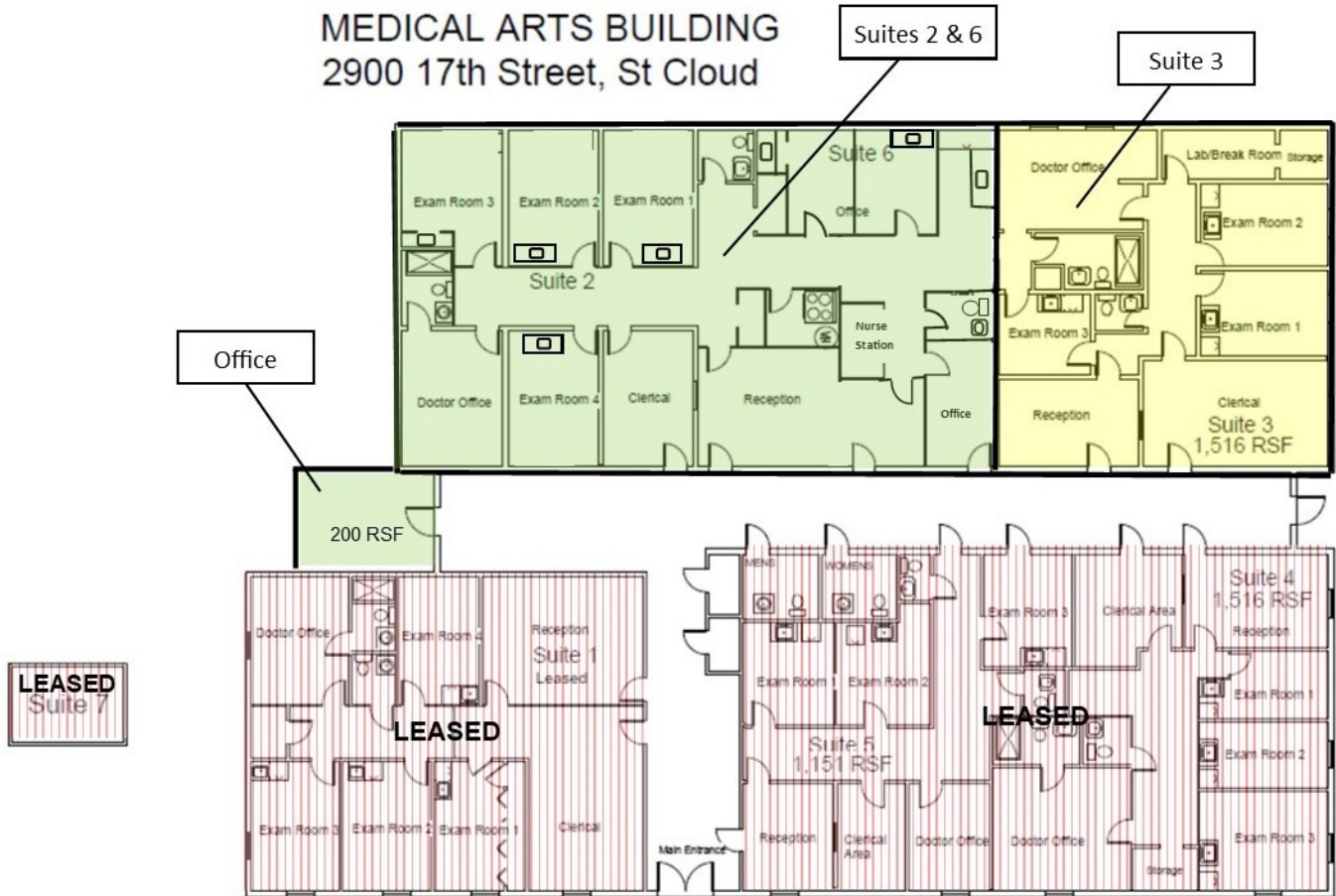

ALL DIMENSIONS & CONDITIONS ARE APPROXIMATE

<b>Available Space:</b>	
Stes 2, 6, & Office:	2,926 RSF
Suite 3:	1,516 RSF
<b>Total:</b>	<b>4,442 RSF</b>

**Southeastern Realty Group**  
 933 Lee Road, Suite 400, Orlando, Florida 32810  
 407-629-5595 phone, 407-645-2035 fax  
 Visit our website at [www.southeasternrealty.com](http://www.southeasternrealty.com)